

PV Rail Shed Extension – Infrastructure Project

Shed Sketch

2 Wall sections using 10' 2x4s, 120" long 51" inside, 54" high, Roof extends a foot on each end to match the main roof and hold the gutter, held up by the 2x6

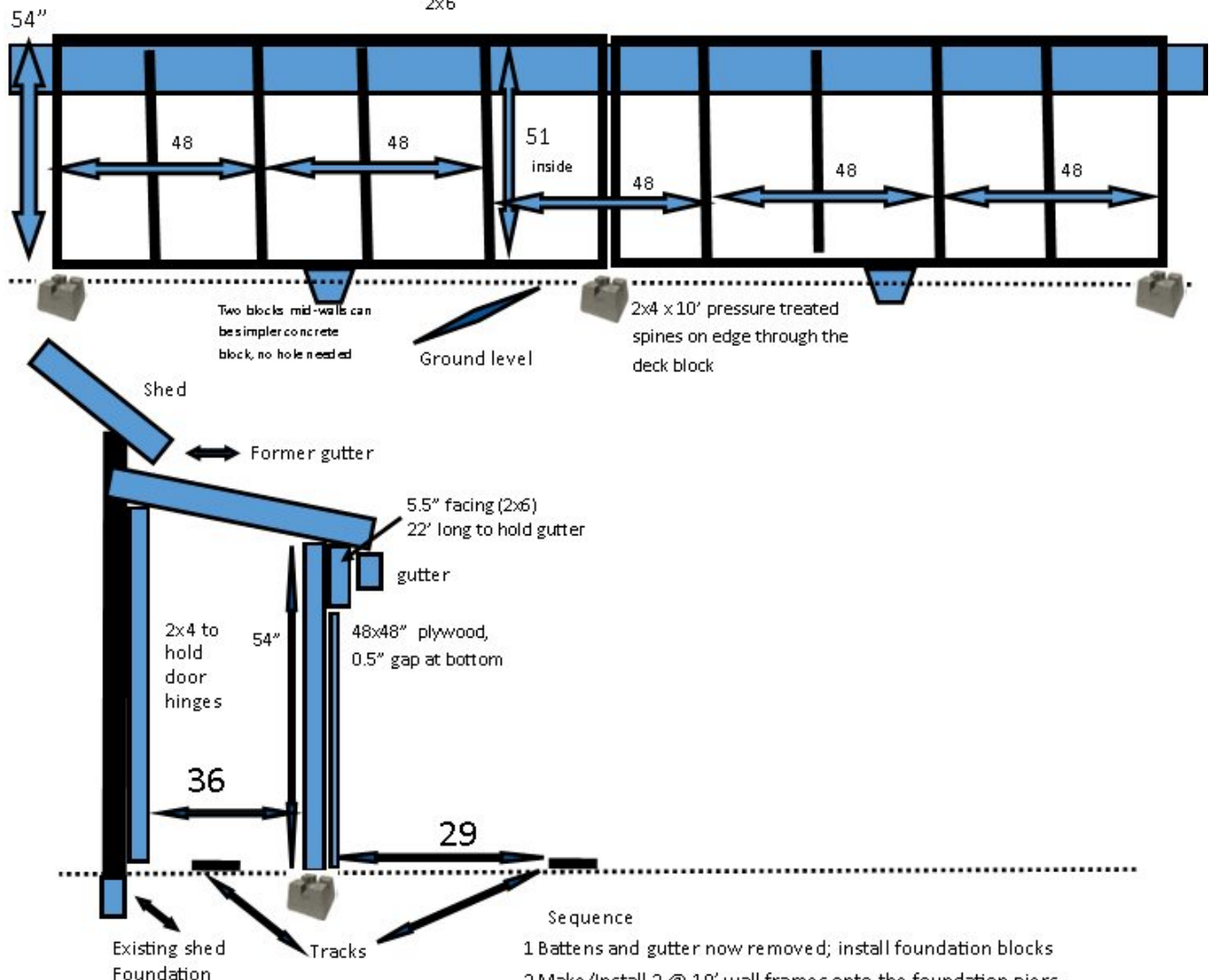

- 1 Batts and gutter now removed; install foundation blocks
- 2 Make/Install 2 @ 10' wall frames onto the foundation piers.
- 3 Make/install 1x4 cross pieces to a 2x6 on shed to hold metal roof
- 4 Screw plywood onto walls
- 5 Cut and install metal roof, less than 46". Protect edge with gutter
- 6 Add plywood doors to front with lock, back with inside bolt
- 7 Plywood on the the 20' long wall may need removal, so use minimum needed screws to fasten
- 8 add fake window decoration or mural later



roof detail, using 1x4" . 37" every two feet connecting wall to the shed; then three at 22 feet long to hold the metal roof nails

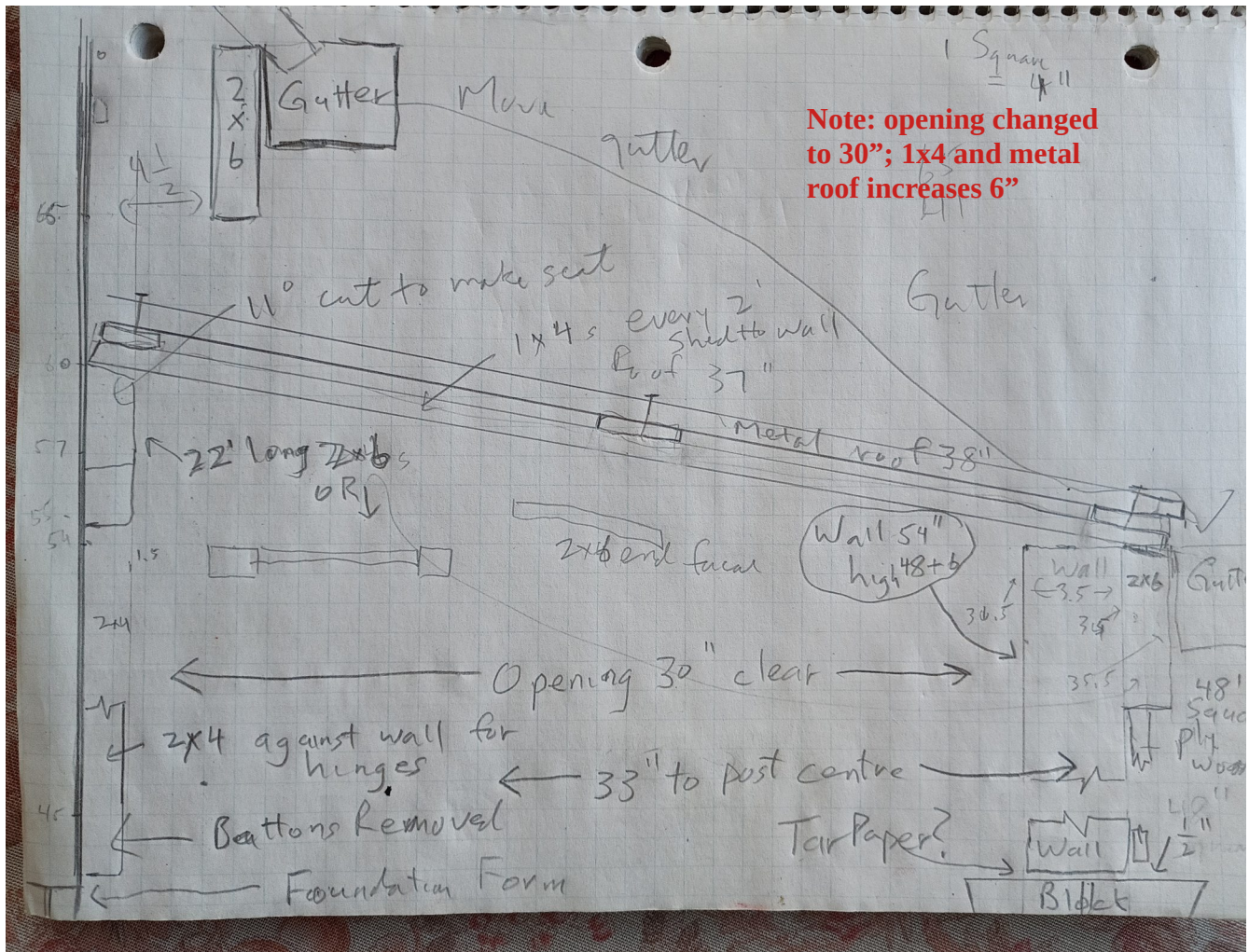

Shed Extension material cost

A lean-to on the north side of the old shed

Item Description

4' x 20' x 5' high lean-to shed, metal roof

- metal roof – 4 sheets 36" x 8 ft. @\$62	\$250
- 5 @ SmartSide 38 Series Primed Engineered Treated Wood Siding Panel 0.375-in x 48-in x 96-in @ \$60	\$300
- 2x6: 44 feet + 8'; (4 x 8' + 2 x 10') @\$1.25/ft	\$65
- 2"x4" x 10' SPF ft qty 14 @ \$8; 20' PT	\$130
- 12 @ 1x4 x 10'	\$60
- screws, hinges, lock, paint	\$80
Five post blocks 14	\$70

++

Total Material Cost, not including GST/PST	\$955
pst/gst .12 * 857	\$120
10% contingency	\$125
Total Project Cost, with GST/PST	\$1200

DRAFT

Invert these, use a 2x4 spine



Could decorate the shed extension walls with something that looks like the windows on real train sheds

